

I N S T E O N[®]



Hidden Door Sensor
Owner's Manual

Contents

Getting Started

| | |
|-------------------------------|---|
| Hidden Door Sensor | 4 |
| Device Overview | |
| Tools Needed for Installation | |
| Test Your Location First | |
| Install in a Window Frame | |

Installation

| | |
|------------------|---|
| Link First | 6 |
| Locate the Hole | |
| Drill the Hole | |
| Test the Fit | |
| Using the Spacer | 7 |

Insteon Links

| | |
|-------------------------------------|----|
| Linking to the Insteon Hub | 9 |
| Linking to Control Another Device | 10 |
| Already Installed Linking | 11 |
| Multi-Linking or Making a Scene | 13 |
| Unlinking a Device | 14 |
| Multi-Unlinking or Removing a Scene | 15 |

Local Programming

| | |
|-------------------|----|
| Local Programming | 18 |
|-------------------|----|

Factory Reset

| | |
|---------------|----|
| Factory Reset | 21 |
|---------------|----|

Software-Only Features

| | |
|------------------------------|----|
| Enable Group 1 & 2 Broadcast | 23 |
| Disable Local Programming | |
| Disable LED and Beeper | |
| Adjust Heartbeat Interval | |
| Low Battery Warning | 24 |

Appendix

| | |
|-----------------------------|----|
| Specifications | 26 |
| Troubleshooting | 29 |
| Certifications and Warnings | 30 |
| Product Warranty | 32 |

Getting Started

Everything you need to quickly get up and running.

Hidden Door Sensor

Device Overview

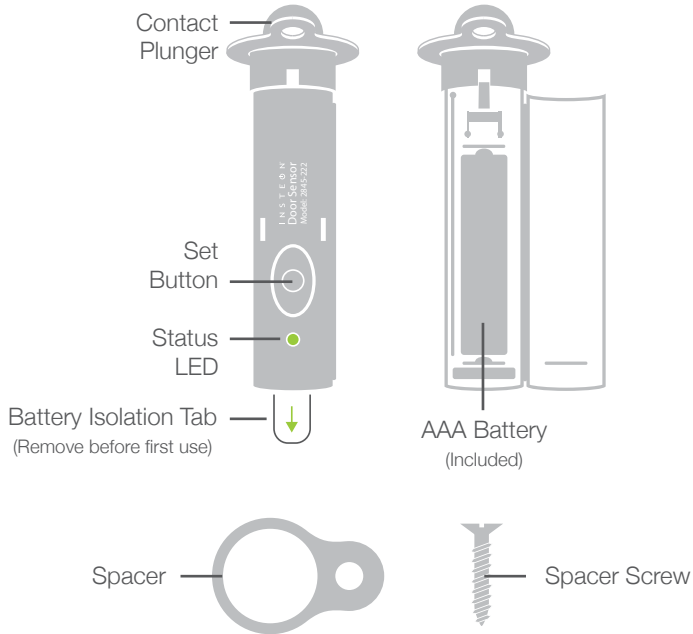

Tools Needed for Installation



Power Drill



3/4-inch Spade or Auger Drill Bit



Phillips Screwdriver

Test Your Location First

Test your desired location first. Hold the Door Sensor in its intended location and try linking to your Hub or responder. If linking is unsuccessful, try repositioning the sensor or add a Range Extender.

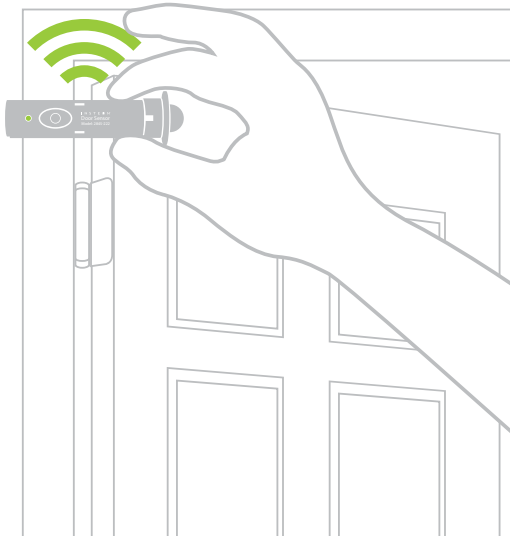

Install in a Window Frame

If installing in a window frame, Door Sensor works best with casement windows. Follow the same installation steps. Insteon recommends using Open/Close Sensor (2843-222) for sash windows.



Installation

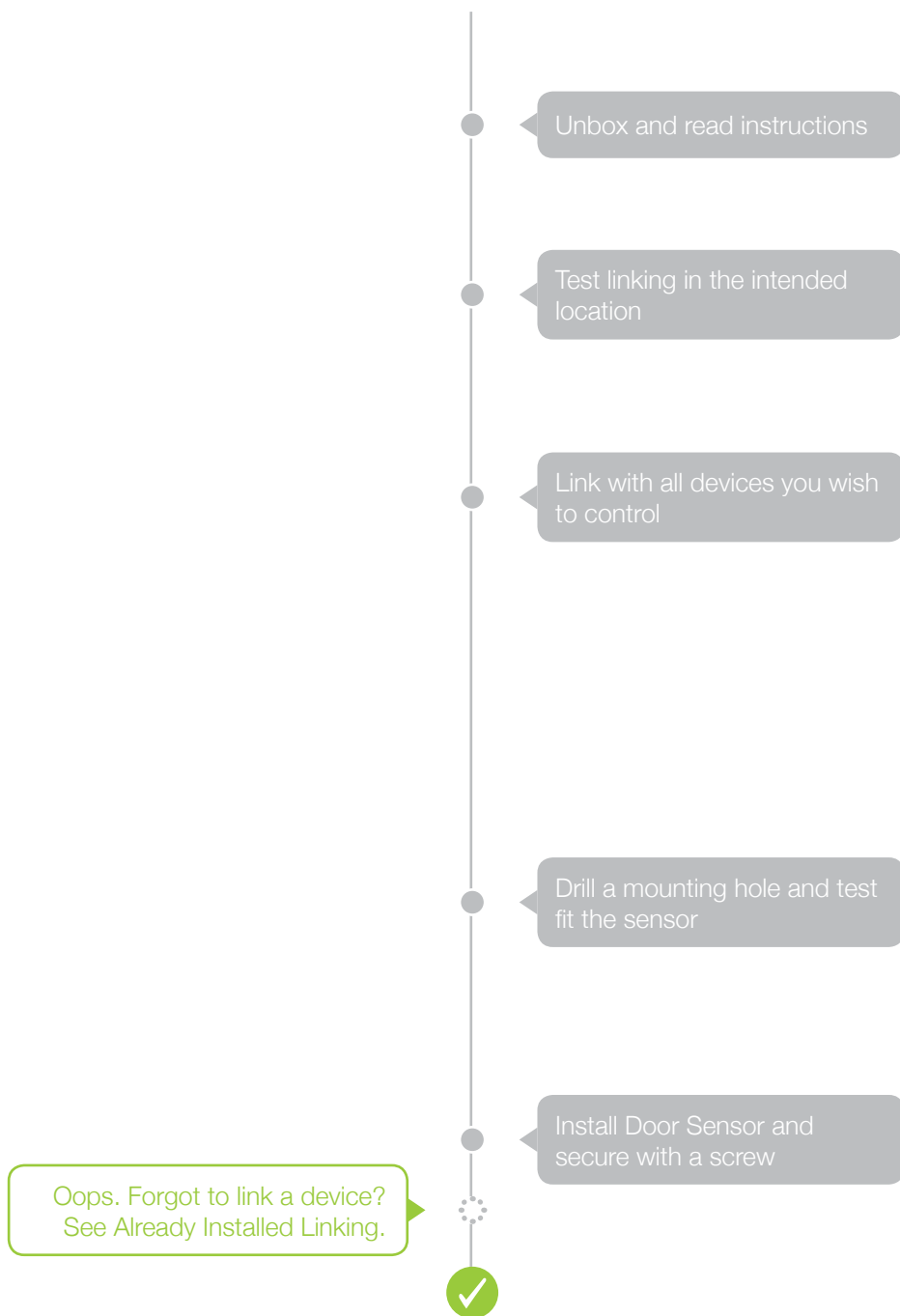

Installation

Link First

- 1 As installing Door Sensor obscures its set button, perform any linking now before you install the sensor.

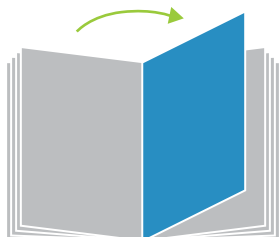

For linking instructions, turn to Page 9.

? If you skip linking now, you can link later using Five-Tap linking.

Locate the Hole

- 2 Find a location for Door Sensor in either the hinge-side of the door frame or the hinge-side of the door itself. Higher is better for wireless range but low will still work.

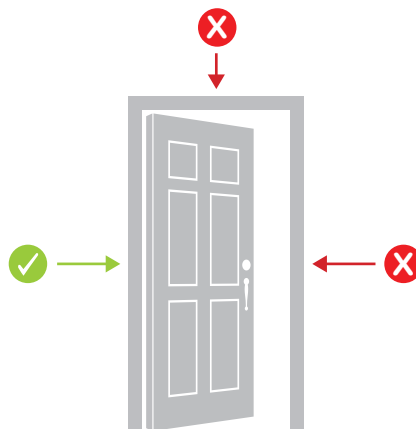

Drill the Hole

- 3 Place masking tape over any surfaces that may be marred by the drill chuck and drill a 4-inch deep, 3/4-inch diameter hole. If drilling into the door, have an assistant hold the door steady.

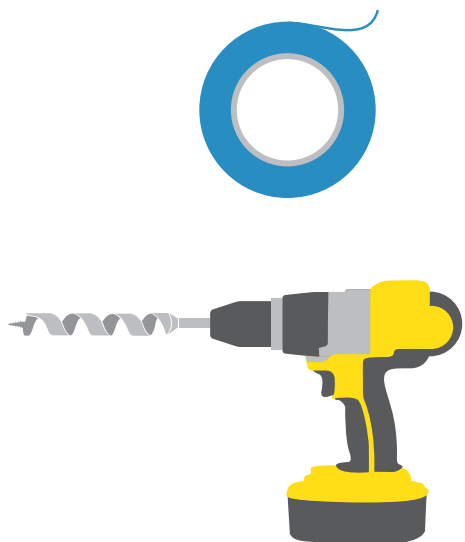

Test the Fit

- 4 Clean out any wood shavings with a vacuum and test fit the sensor. When ready, insert the sensor into the hole and fasten with the included screw.

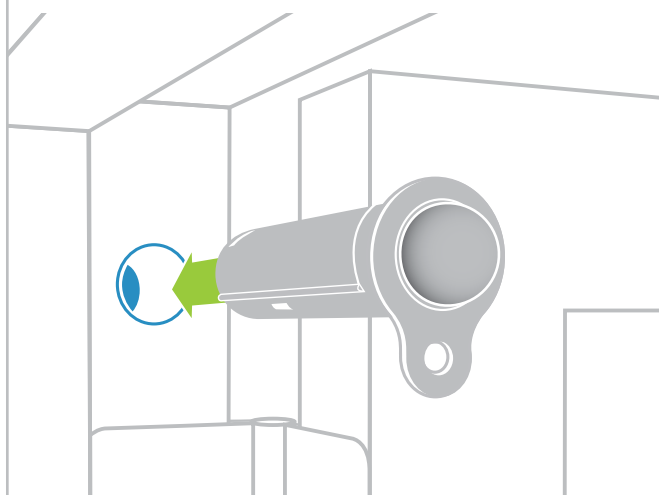

✓ Installation of your Door Sensor is now complete.

Using the Spacer

If the gap between your door and door frame is too wide to depress the contact plunger, try using the spacer.

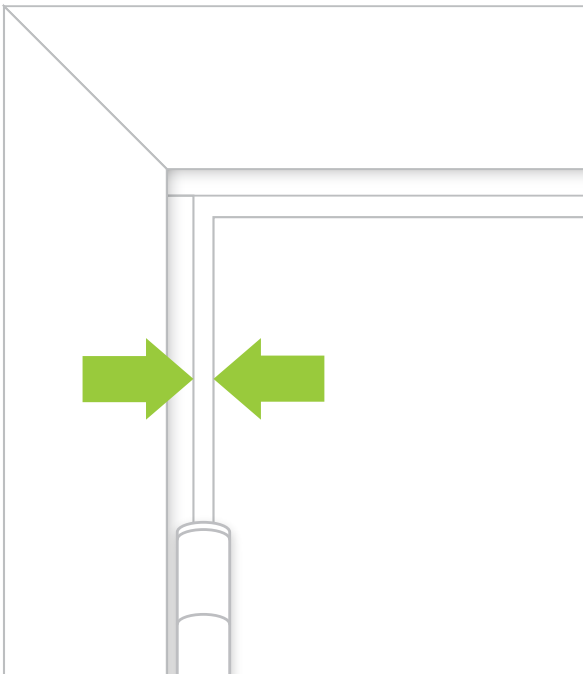

Slide the spacer over Door Sensor to increase the thickness of the collar. Fasten with the screw provided.



Insteon Links

Insteon devices can stand alone and function as a local switch or dimmer, but their real power comes when they are connected together to form a control system. Most Insteon devices can control one another and be the recipient of control. The process of associating multiple Insteon devices to one another is called Linking.

Linking to the Insteon Hub

- 1 From Rooms, navigate to All Devices.

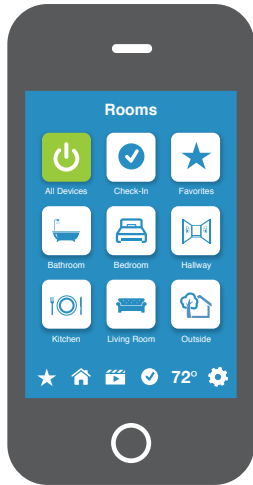

- 2 Tap the Add button.

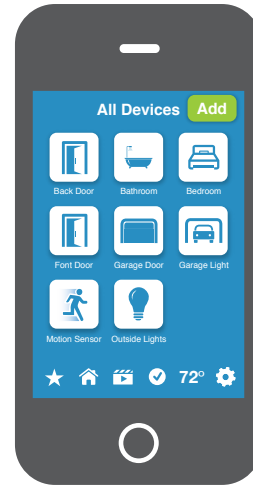

- 3 Select Door Sensor from the list of devices.

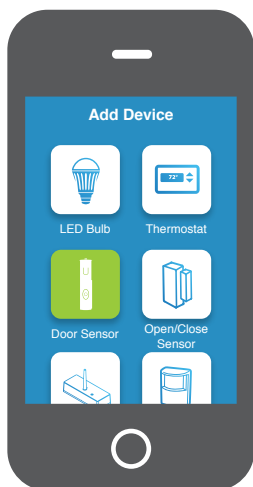

- 4 When prompted, press and hold the set button on your Door Sensor until the device beeps.

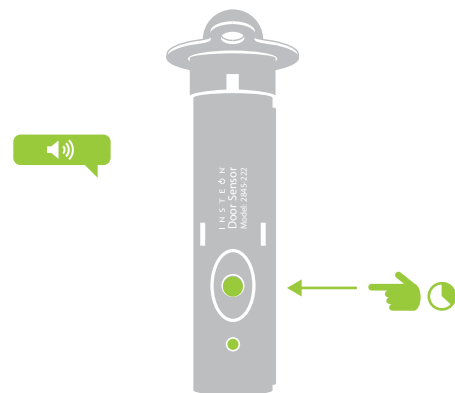

✓ Your Door Sensor is now added to your Insteon Hub.

Linking to Control Another Device

- 1 On your Door Sensor, press and hold the set button until the device beeps.

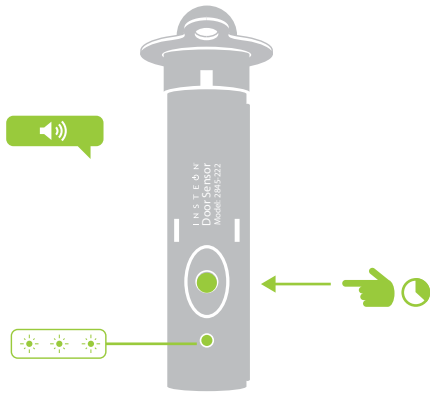

- 2 Adjust your responder to the desired state: On, off, or brightness level if dimming, and then press and hold the set button until the device double-beeps.

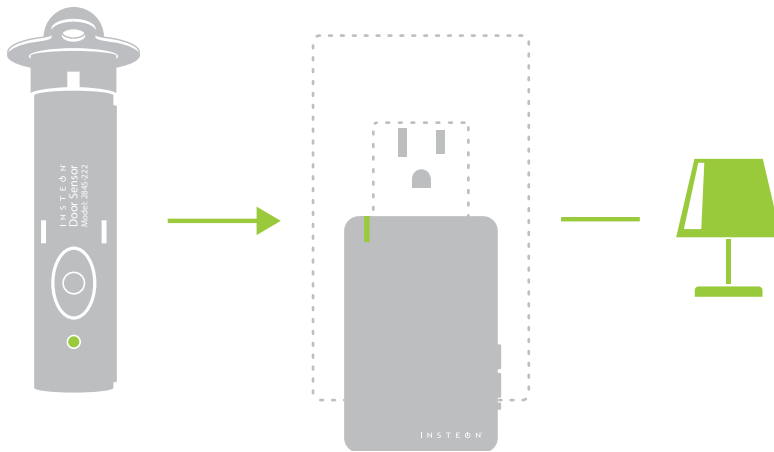
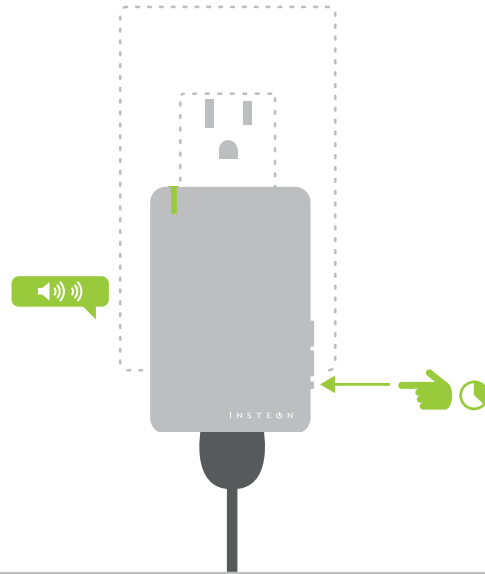

✓ Your Insteon controller will now control your On/Off Module.

Already Installed Linking

Link Hidden Door Sensor without removing from your door frame

If Your Door Is Already Open

- 1 Press and release Door Sensor's contact plunger twice then hold the contact plunger until Door Sensor beeps.

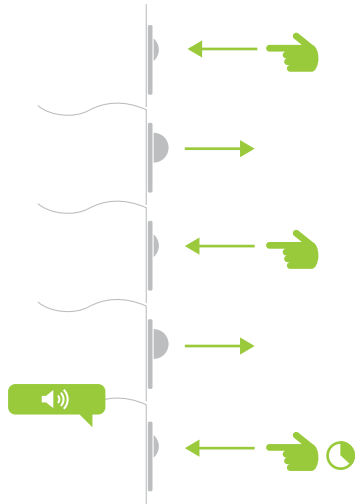

OR

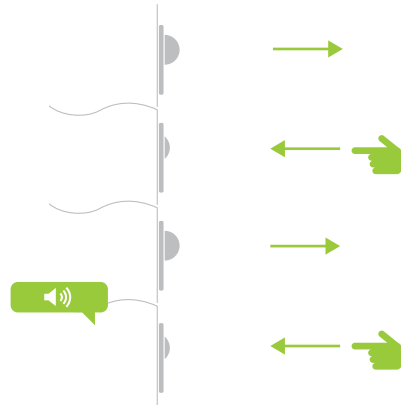

- ? Once in linking mode, you can open or close the door without exiting linking mode.

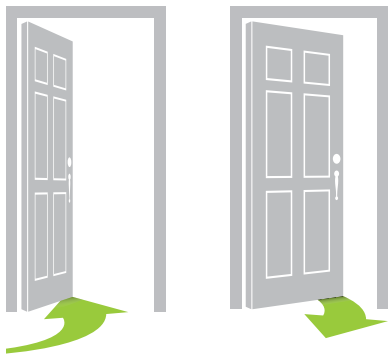

- ? You can cycle between Linking and Unlinking by repeating the Five-Tap Linking process.

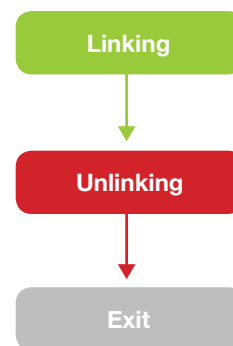

Already Installed Linking

Link Hidden Door Sensor without removing from your door frame

- 2 Adjust your responder to the desired state: On, off, or brightness level if dimming, and then press and hold the set button until the device double-beeps.

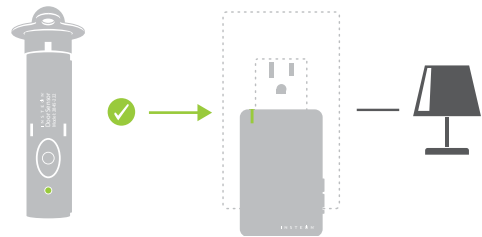
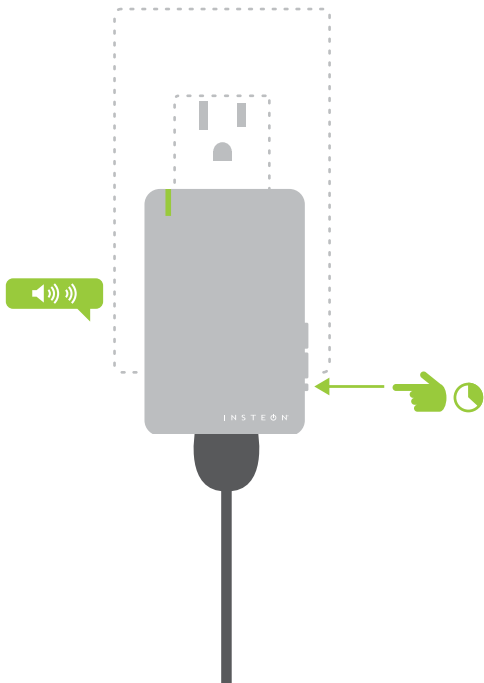

✓ Your Insteon controller will now control your On/Off Module.

Multi-Linking or Making a Scene

- 1 On your Door Sensor, press and hold the set button until the device beeps then tap the set button.

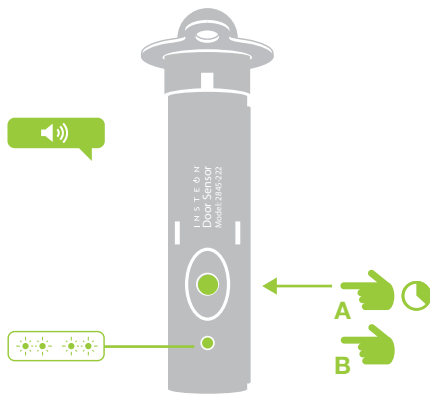

- 2 Adjust your scene members to their desired state: On, off, or brightness level if dimming.

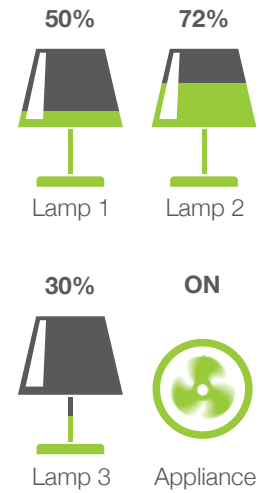

- 3 One at a time, press and hold the set button on each scene member until it double-beeps.

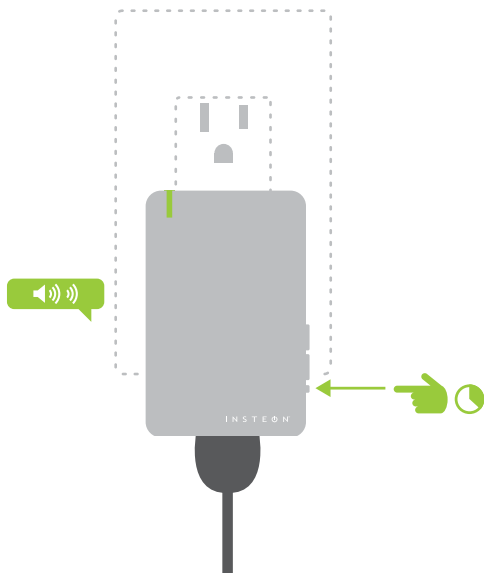

- 4 Tap the set button on your Door Sensor to finish building your scene.

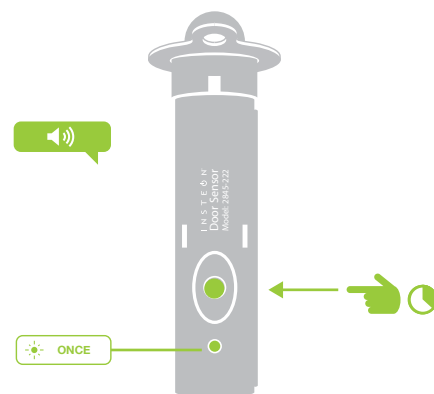

✓ Your Door Sensor will now control your scene.

Unlinking a Device

- 1 On your Door Sensor, press and hold the set button until the device beeps.

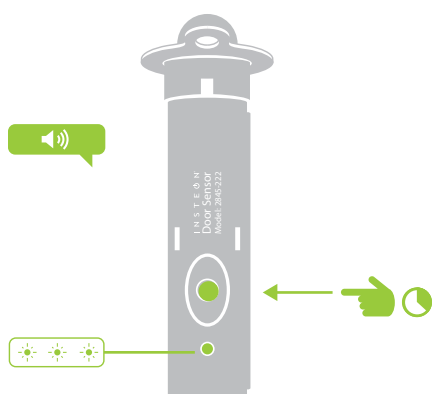

- 2 Press and hold the set button again until the device beeps.

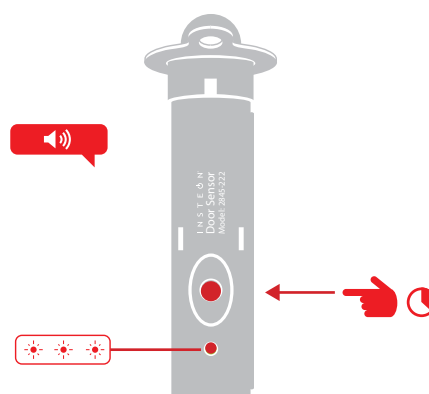

- 3 Press and hold the controlled device's set button until the device double-beeps.

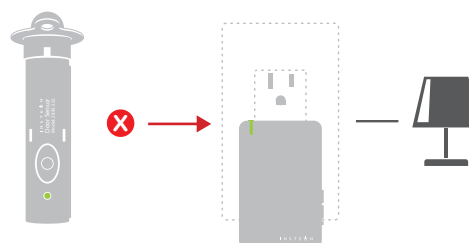
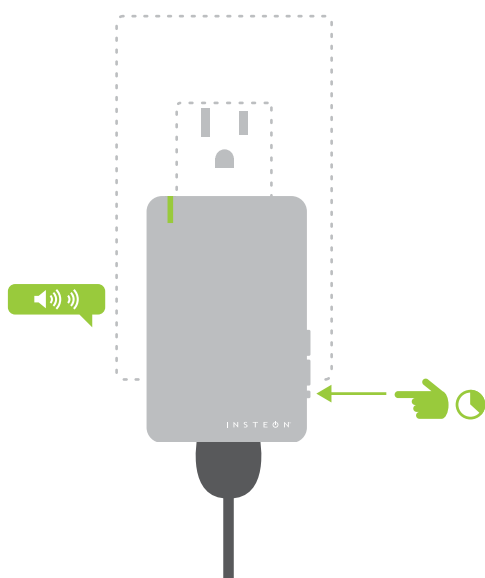

✓ Your Door Sensor will no longer control your Insteon device.

Multi-Unlinking or Removing a Scene

- 1 On your Door Sensor, press and hold the set button until the device beeps.

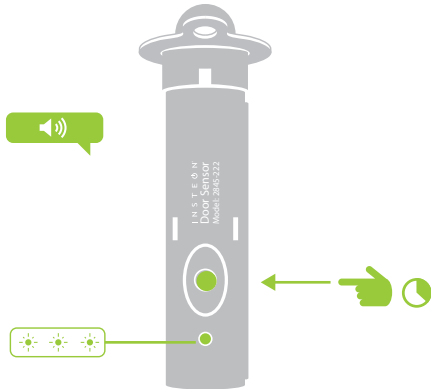

- 2 Press and hold the set button again until the device beeps.

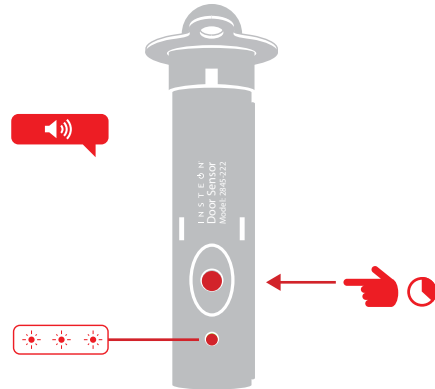

- 3 Tap the set button.

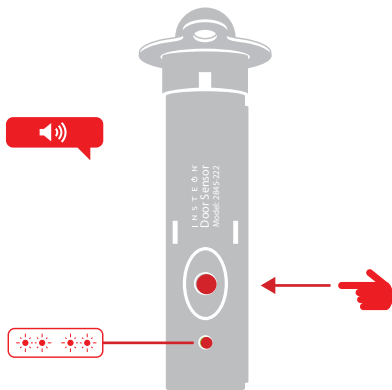

- 4 Press and hold the controlled device's set button until the device double-beeps.

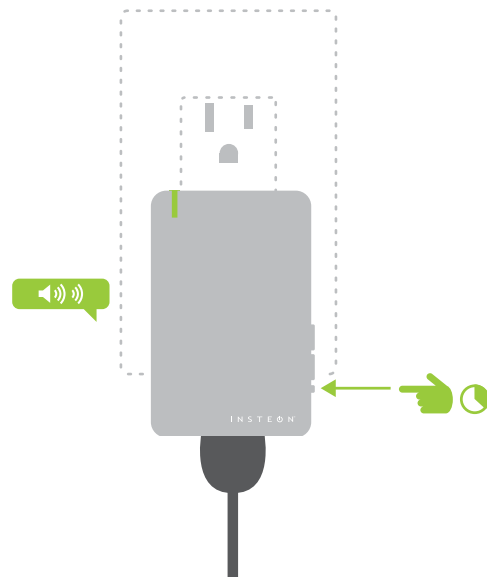

Multi-Unlinking or Removing a Scene

- 5 Tap the set button on your Door Sensor to exit Multi-Unlinking mode.

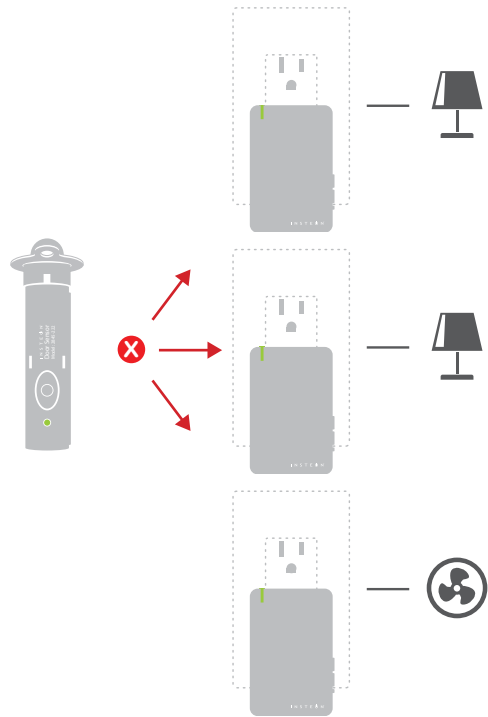
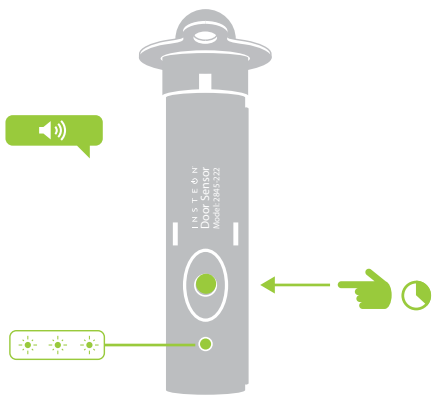

✓ Your Door Sensor will no longer control your Insteon responders.

Local Programming

Encompassing all on-device programming options, use the local programming to set local properties and factory reset. For the best experience, use software for managing device properties.

Local Programming

About the Flow Chart

Local Programming is a visual representation of the device's settings. Many device features can be configured using the flow chart. Some devices have more options than others but the programming wheel presents even the most complicated devices with a straightforward, navigable path.

Navigation



To move right, press and hold the set button



To move down, tap the set button



Status LED blinks green



Status LED double-blinks green



Status LED blinks red



Status LED double-blinks red

Local Programming Features

| | |
|----------------------|--|
| Linking Mode | Readies the module for linking to another Insteon module. As linking is directional, the first device placed into linking mode will become the controller in the controller/responder relationship. The second device will become the responder. The device automatically exits linking mode after a link has been made with another Insteon device. |
| Multi-Linking Mode | Readies the module for linking to multiple Insteon modules. The module will remain in linking mode for 4 minutes or until the module's set button is tapped. This mode is very usefully for manually creating scenes. |
| Unlinking Mode | Allows the removal of links from the Insteon module. The device will automatically exit unlinking mode after a link has been removed from another Insteon device. |
| Multi-Unlinking Mode | Allows the removal of multiple links from the Insteon module. The device will stay in unlinking mode for 4 minutes or until the device's set button is tapped. |

Local Programming

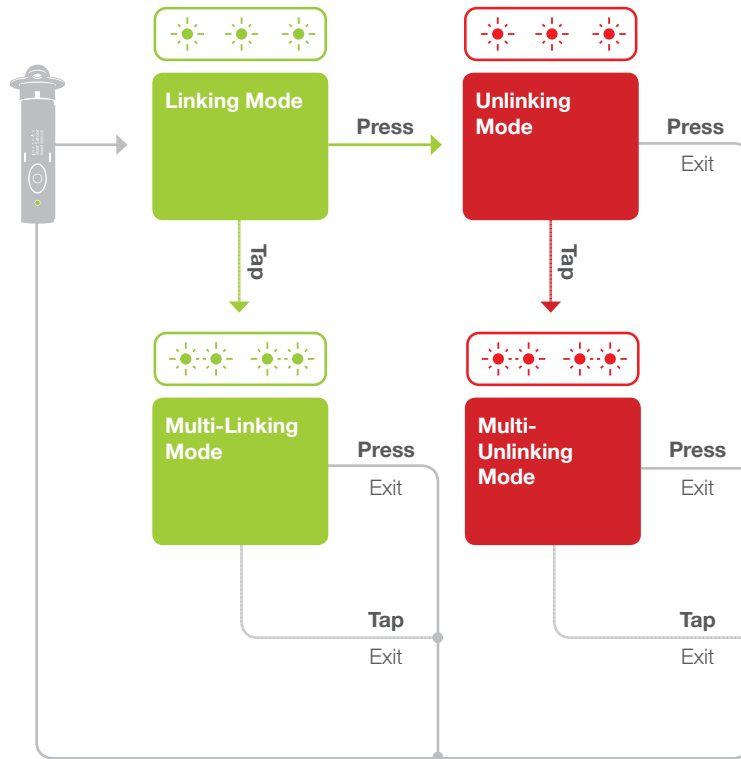

Factory Reset

A factory reset will erase all links stored in the device's database as well as any customized properties.

Factory Reset

- 1 Remove Door Sensor from the door frame and take out the sensor's battery.

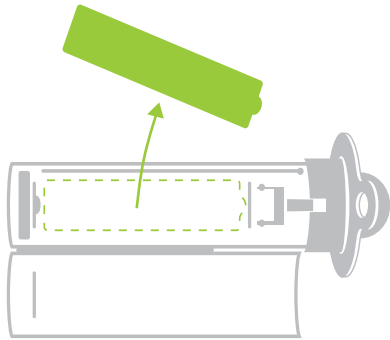

- 2 Press and hold the set button while reinstalling the battery.

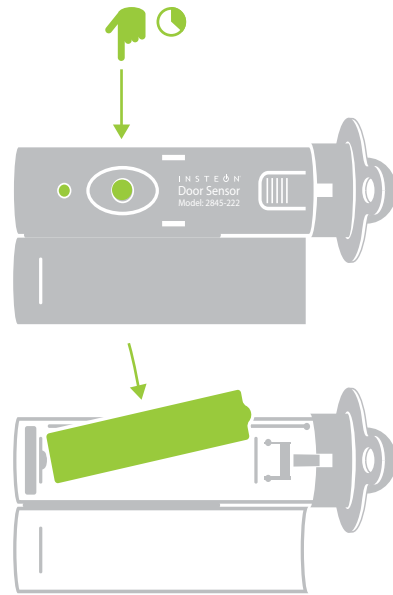

- 3 Continue to hold the set button until the long beep stops. Let go and Door Sensor will emit a double-beep.

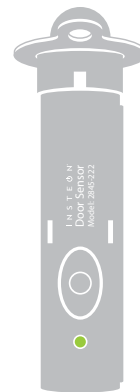
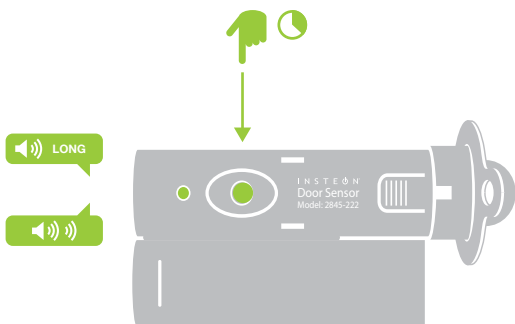

✓ Your Door Sensor has been restored to factory settings.

Software-Only Features

Most Insteon devices contain features that can only be enabled, disabled or modified using Insteon control software such as HouseLinc and an Insteon PowerLine Modem.

Software-Only Features

Enable Group 1 & 2 Broadcast

When enabled, Door Sensor will send a separate On for opening and for closing. Useful if you want a device to turn on when the door closes, like a bathroom fan.

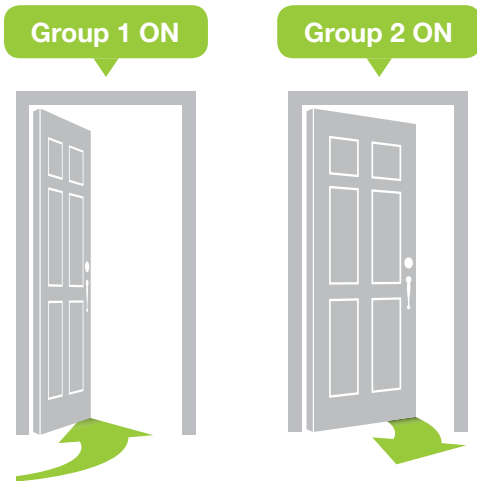

Disable Local Programming

Prevents changing any settings using the set button or tap-and-hold programming.

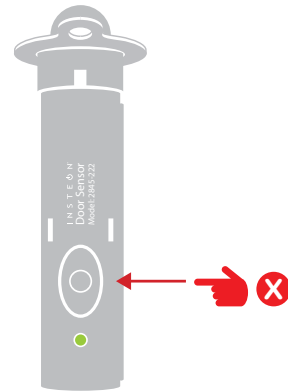

Disable LED and Beeper

The status LED will not blink when the sensor is triggered and the beeper will not respond to button presses.

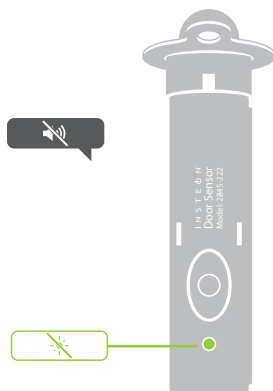

Adjust Heartbeat Interval

Customize the duration of time between sensor check-ins; by default, the sensor will broadcast it's state once every 24 hours.

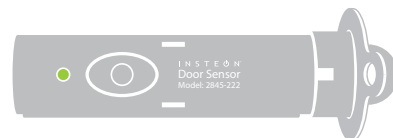

Software-Only Features

Low Battery Warning

Enable or disable a low battery broadcast that can trigger events with software.



Appendix

Everything else you might need to know about your Insteon product.

Specifications

General

| | |
|------------------|---|
| Available Colors | White |
| Brand | Insteon |
| FCC ID | SPB28452 |
| Industry Canada | 5202A-28452 |
| Product Number. | 2845-222 US 2845-422 EU 2845-522 AUS/NZ |
| Patent | Protected under US and Freign Patents (see www.insteon.com/patents) |
| UPC | 813922013092 US 813922013603 EU 813922013610 AUS/NZ |
| Warranty | 2 years, limited |

Operation

| | |
|-----------------|--|
| Audio Alert | Beeper, can be disabled through software |
| Operation Modes | Insteon only |
| Operational Gap | Direct contact with contact plunger required |
| Setup Memory | Non-volatile EEPROM |
| Status LED | Red/Green LED |

Insteon Features

| | |
|----------------------------|-----------------------------------|
| Insteon Addresses | 400 |
| Insteon Device Category | 0x10 |
| Insteon Device Subcategory | 0x11 US 0x14 EU 0x15 AUS/NZ |
| Insteon ID | 1 |
| Insteon Links | 417 |
| Insteon Messages Repeated | No |
| Insteon Powerline Device | No |
| Insteon RF Device | Yes |
| Maximum Controlled Scenes | 2 |

Specifications

| | |
|--|---|
| Maximum Scene Memberships | 1 |
| Multi-Link Support | Yes |
| Multi-Unlink Support | Yes |
| Phase Detect Beacon | No |
| Radio Frequency | 915 MHz US 869.85 MHz EU 921 MHz AUS/NZ |
| Radio Frequency Range | 150 feet |
| Scene Commands Supported as Controller | On Off |
| Scene Commands Supported as Responder | None |
| Software Configurable | Yes |

Mechanical

| | |
|-----------------------------|---|
| Switch Type | Momentary mechanical switch |
| Dimensions | 0.75" diameter, 3.4" length 15.9mm diameter, 87mm length |
| Enclosure Material | Plastic |
| Mounting | 0.75" diameter, 3.1" deep hole in door frame or door 19mm diameter, 79mm deep hole in door frame or door |
| Operating Environment | Indoors |
| Operating Humidity Range | 0-90% relative humidity, non-condensing |
| Operating Temperature Range | -40° to 104° F -40° to 40° C |
| Set Button | 1, recessed. Requires removal of sensor to access |
| Storage Temperature Range | -40° to 104° F -40° to 40° C |
| Weight | 0.64 oz 20g |

Specifications

Electrical

| | |
|-------------------|-----------------------------|
| Battery Type | AAA |
| Battery Life | 6 months |
| Certification | N/A, Battery-powered device |
| Power Consumption | 60 μ A |
| Supply Voltage | 1.5V DC (AAA Battery) |

X10 Features (Powerline Only)

| | |
|-------------|----|
| X10 Support | No |
|-------------|----|

Troubleshooting

Door Sensor won't link to other Insteon Devices

Your Door Sensor may be out of range of a dual-band Insteon device or your network may be powerline-only.

Try this:

- If your Insteon network lacks any dual-band devices, add a Range Extender or other dual-band Insteon device near your Door Sensor to bridge the Insteon RF and powerline networks.
- Door Sensor must be placed within 100' of a dual-band device. Radio interference and building construction may reduce range. Relocate a dual-band device or add a Range Extender to increase RF coverage.

Status LED flashes rapidly after triggering Door Sensor's contact plunger

While you can only see the Status LED when Door Sensor is removed from the door frame, this blinking indicates that Door Sensor may have not received acknowledgment from one or more linked devices.

Try this:

- If you have removed any Insteon devices from your network that were previously controlled by Door Sensor, unlink them from Door Sensor. If the removed device is no longer available, use software to remove the link from Door Sensor's link table or perform a factory reset to clear all links.
- Door Sensor may be on the fringe of your Insteon RF network. Add an additional Insteon dual-band device or Range Extender near Door Sensor for improved RF and powerline signal bridging.

Status LED does not flash when the set button is tapped or when the contact plunger is depressed

Your Door Sensor's battery may be low and require replacement.

Try this:

- Remove Door Sensor from the retention collar and try a different AAA battery.

Hidden Door Sensor makes a hissing noise when installing a new battery

A faint hissing noise can often be heard when removing the battery isolation tab or installing a new battery.

Try this:

- This is normal operating behavior for Hidden Door Sensor. The noise is part of the startup diagnostics performed by the sensor..

Certifications and Warnings

This device complies with FCC Rules and Industry Canada license-exempt RSS standard(s). Operation is subject to the following two conditions: (1) this device may not cause harmful interference, and (2) this device must accept any interference, including interference that may cause undesired operation of the device.

Le present appareil est conforme aux CNR d'Industrie Canada applicables aux appareils radio exempts de licence. L'exploitation est autorise aux deux conditions suivantes: (1) l'appareil ne doit pas produire de brouillage, et (2) l'utilisateur de l'appareil doit accepter tout brouillage radioelectrique subi, mme si le brouillage est susceptible d'en compromettre le fonctionnement.

Changes or modifications to this unit voids the user's authority to operate this product and the manufacturer's warranty.

The digital circuitry of this device has been tested and found to comply with the limits for a Class B digital device, pursuant to Part 15B of the FCC Rules. These limits are designed to provide reasonable protection against harmful interference in residential installations. This equipment generates, uses, and can radiate radio frequency energy and, if not installed and used in accordance with the instructions, may cause harmful interference to radio and television reception. However, there is no guarantee that interference will not occur in a particular installation. If this device does cause such interference, which can be verified by turning the device off and on, the user is encouraged to eliminate the interference by one or more of the following measures:

- Re-orient or relocate the receiving antenna of the device experiencing the interference
- Increase the distance between this device and the receiver
- Connect the device to an AC outlet on a circuit different from the one that supplies power to the receiver
- Consult the dealer or an experienced radio/TV technician

WARNING: Changes or modifications to this device not expressly approved by the party responsible for compliance could void the user's authority to operate the equipment.

DECLARATION OF CONFORMITY

Hereby, Insteon declares that this device is in compliance with the essential requirements and other relevant provisions of the following Directives:

- 1) Electromagnetic Compatibility Directive 2004/108/EC
- 2) Hazardous Substance Directive 2005/95/EC

Technical data and copies of the original Declaration of Conformity are available and can be obtained from Insteon; 16542 Millikan Ave, Irvine, CA, USA.

User Information for Consumer Products Covered by EU Directive 2002/96/EC on Waste Electric and Electronic Equipment (WEEE)

This document contains important information for users with regards to the proper disposal and recycling of Insteon products. Consumers are required to comply with this notice for all electronic products bearing the following symbol:

Environmental Information for Customers in the European Union

European Directive 2002/96/EC requires that the equipment bearing this symbol on the product and/or its packaging must not be disposed of with unsorted municipal waste. The symbol indicates that this product should be disposed of separately from regular household waste streams.

Certifications and Warnings

It is your responsibility to dispose of this and other electric and electronic equipment via designated collection facilities appointed by the government or local authorities. Correct disposal and recycling will help prevent potential negative consequences to the environment and human health.

For more detailed information about the disposal of your old equipment, please contact your local authorities, waste disposal service, or the shop where you purchased the product.

DECLARATION OF CONFORMITY TO R&TTE DIRECTIVE 1999/5/EC for the European Community, Switzerland, Norway, Iceland and Liechtenstein

Product category: general consumer (category 3).

English: This equipment is in compliance with the essential requirements and other relevant provisions of the European R&TTE Directive 1999/5/EC

Deutsch [German]: Dieses Gerät entspricht den grundlegenden Anforderungen und den weiteren entsprechenden Vorgaben der Richtlinie 1999/5/EU.

Nederlands [Dutch]: Dit apparaat voldoet aan de essentiële eisen en andere van toepassing zijnde bepalingen van de Richtlijn 1999/5/EC.

Svenska [Swedish]: Denna utrustning står i överensstämmelse med de väsentliga egenskapskrav och övriga relevanta bestämmelser som framgår av direktiv 1999/5/EG.

Français [French]: Cet appareil est conforme aux exigences essentielles et aux autres dispositions pertinentes de la Directive 1999/5/EC

Español [Spanish]: Este equipo cumple con los requisitos esenciales así como con otras disposiciones de la Directiva 1999/5/CE.

Português [Portuguese]: Este equipamento está em conformidade com os requisitos essenciais e outras provisões relevantes da Directiva 1999/5/EC. Italiano [Italian]: Questo apparato é conforme ai requisiti essenziali ed agli altri principi sanciti dalla Direttiva 1999/5/CE.

Norsk [Norwegian]: Dette utstyret er i samsvar med de grunnleggende krav og andre relevante bestemmelser i EU-direktiv 1999/5/EF.

Suomi [Finnish]: Tämä laite täyttää direktiivin 1999/5/EY olennaiset vaatimukset ja on siinä asetettujen muiden laitetta koskevien määräysten mukainen. Dansk [Danish]: Dette udstyr er i overensstemmelse med de væsentlige krav og andre relevante bestemmelser i Direktiv 1999/5/EF.

Polski [Polish]: Urządzenie jest zgodne z ogólnymi wymaganiami oraz szczególnymi warunkami określonymi Dyrektywą UE: 1999/5/EC

Product Warranty

Limited Warranty

Seller warrants to the original consumer purchaser of this product that, for a period of two years from the date of purchase, this product will be free from defects in material and workmanship and will perform in substantial conformity to the description of the product in this Owner's Manual. This warranty shall not apply to defects or errors caused by misuse or neglect. If the product is found to be defective in material or workmanship, or if the product does not perform as warranted above during the warranty period, Seller will either repair it, replace it, or refund the purchase price, at its option, upon receipt of the product at the address below, postage prepaid, with proof of the date of purchase and an explanation of the defect or error. The repair, replacement, or refund that is provided for above shall be the full extent of Seller's liability with respect to this product. For repair or replacement during the warranty period, call 866-243-8022 with the Model # and Revision # of the device to receive an RMA# and send the product, along with all other required materials to:

Insteon
ATTN: Receiving
16542 Millikan Ave.
Irvine, CA 92606-5027

Limitations

The above warranty is in lieu of and Seller disclaims all other warranties, whether oral or written, express or implied, including any warranty of merchantability or fitness for a particular purpose. Any implied warranty, including any warranty of merchantability or fitness for a particular purpose, which may not be disclaimed or supplanted as provided above shall be limited to the two-year of the express warranty above. No other representation or claim of any nature by any person shall be binding upon Seller or modify the terms of the above warranty and disclaimer.

Home automation devices have the risk of failure to operate, incorrect operation, or electrical or mechanical tampering. For optimal use, manually verify the device state. Any home automation device should be viewed as a convenience, but not as a sole method for controlling your home.

In no event shall Seller be liable for special, incidental, consequential, or other damages resulting from possession or use of this device, including without limitation damage to property and, to the extent permitted by law, personal injury, even if Seller knew or should have known of the possibility of such damages. Some states do not allow limitations on how long an implied warranty lasts and/or the exclusion or limitation of damages, in which case the above limitations and/or exclusions may not apply to you. You may also have other legal rights that may vary from state to state.